

Note  
Structural suitability of the upstands to withstand the loads imposed by the glazing system, are the responsibility of the structural engineer.

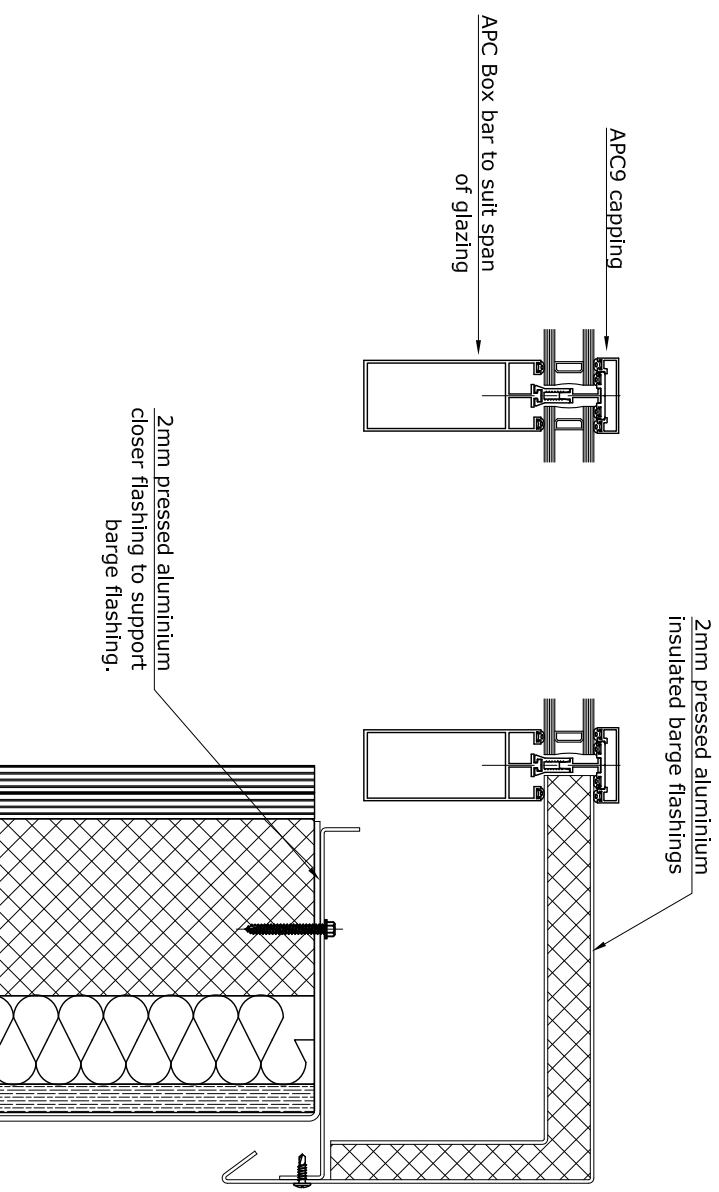

**architectural products limited**

specialised aluminium fabrications for the construction industry  
Unit 9, Alexandra Way, Tewkesbury, Gloucestershire GL20 8NB  
Tel: 01684 291555 Fax: 01684 291666  
www.architecturalproducts.co.uk

Project: XXXX

Client: XXXX

Revisions

Date

By

Specification: xxx

Glass: xxx

Finish:

XX

Title: TYPICAL DETAILS

SELF SUPPORTING ROOFLIGHT  
RIDGE, EAVES & BARGE DETAILS

Scale: xx

Date: xxx

Drawing No.

Drawn: JJO

Checked: